

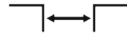

For seismic zone



Top mounted



Joint width 50-500 mm



Movements in 3 directions



Outdoor

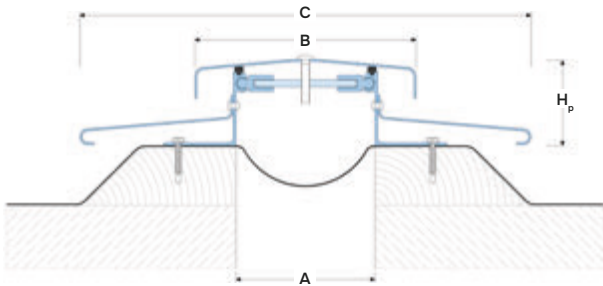

DESIGNATIONS:

A – nominal joint width;
B – full (seat) width;
 H_p – profile height;

M_x – horizontal movements;
 M_y – Y-axis movements.

Profile	Sizes, mm				Movements ² , mm	
	A ¹	B	C	H_p	M_x	M_y
RV 29/50	50	75	175	50	50 (+25/-25)	20 (+10/-10)
RV 29/100	100	150	225	50	100 (+50/-50)	30 (+15/-15)
RV 29/150	150	225	275	50	150 (+75/-75)	40 (+20/-20)
RV 29/200	200	300	325	50	200 (+100/-100)	50 (+25/-25)
RV 29/300	300	450	425	50	300 (+150/-150)	60 (+30/-30)
RV 29/400	400	600	525	50	400 (+200/-200)	70 (+35/-35)
RV 29/500	500	750	625	50	500 (+250/-250)	80 (+40/-40)

¹The profile can be made to any specific expansion joint (A) width from 50 mm (ask for details).

²The indicated movements can be increased upon request up to +/- 100% of the joint width (ask for details).

► TECHNICAL DATA

→ FRAME

Material	Aluminum EN AW 6063 T6
Tolerances	EN 12020-2
Strength, MPa	$\sigma_b = 205$
Length, m	3,0
Tooling	Mounting holes
Fasteners	Included (Screws Rawlplug)
Surface coat	Mill finish

→ COVER AND FLANGE

Material	Aluminum EN AW 5052-H34
Tolerances	EN 573-3
Strength, MPa	$\sigma_b = 265$
Length, m	3,0
Tooling	Mounting holes
Fasteners	Included (screw with o-ring)
Surface coat	Mill finish

► CORNER VERSION

All profiles have a corner version for roof-wall connection. These profiles have the RV-E index.

Example: RV-E 29/50/50

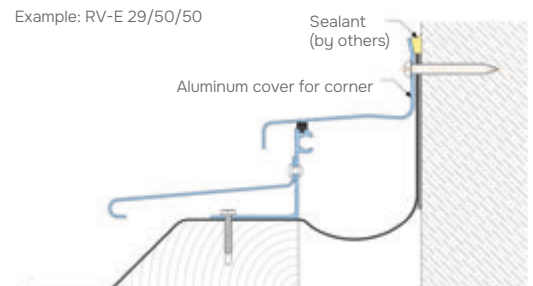

► EQUIPMENT PROFILE

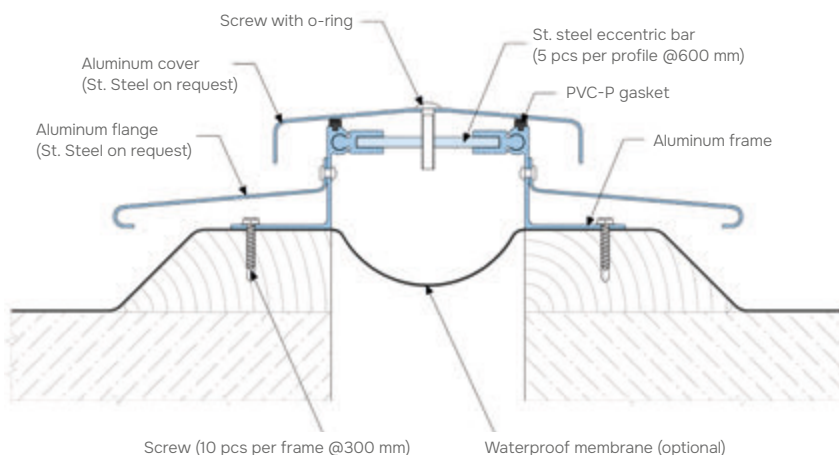

► DESCRIPTION

The profile is designed for the device and design of expansion joints on unexploited roofs. They serve to protect waterproofing from external factors.

The profile can be made to the required width A (mm) of the expansion joint with the specified movement values.

Additionally, it can be equipped with a moisture barrier (waterproof membrane).