

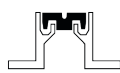

Max load  
300 kN



Recess  
mounted



Joint width  
20-150 mm



Movements  
in 1 directions



Indoor/  
outdoor

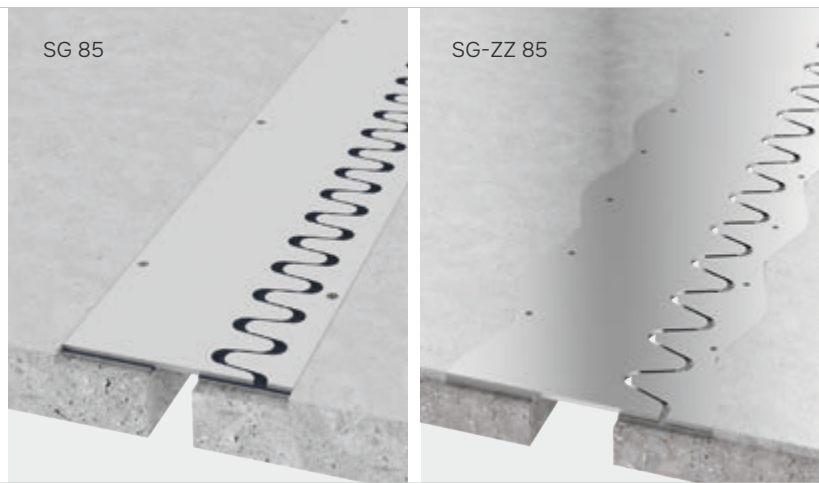

For joint  $\leq 50$  mm

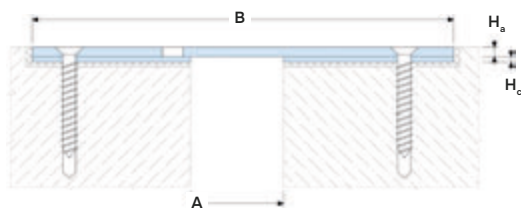

For joint  $> 50$  mm

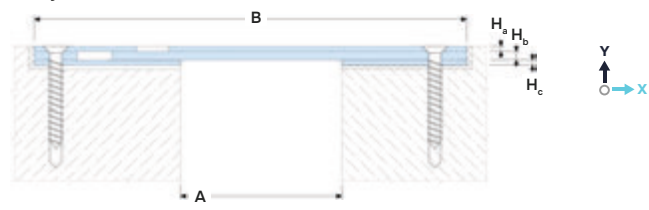

Profile	Standard options <sup>1</sup> (abc)	Sizes, mm			Layer thickness <sup>2</sup> (mm)			Movements <sup>3</sup> , mm		Permissible loads (kN)		
		A	B	H	H <sub>a</sub>	H <sub>b</sub>	H <sub>c</sub>	M <sub>x</sub>	M <sub>y</sub> <sup>4</sup>			
SG 85/20-200/6	BB, HH, 33	20	190	6	3	—	3	30 (+15/-15)	—	300	70	20
SG 85/30-220/6		30	200	6	3	—	3	30 (+15/-15)	—	300	70	20
SG 85/50-230/6		50	220	6	3	—	3	30 (+15/-15)	—	300	70	20
SG 85/80-260/19	BBB, HHH, 333	80	260	10	3	4	3	30 (+15/-15)	—	300	70	15
SG 85/100-280/21		100	280	11	3	5	3	30 (+15/-15)	—	300	50	10
SG 85/120-320/23		120	320	11	3	5	3	30 (+15/-15)	—	300	50	10
SG 85/150-350/25		150	350	11	3	5	3	30 (+15/-15)	—	300	50	10

<sup>1</sup> The profile is made to order from different materials of the components of the profile layers a, b and c (see technical data):

- B – Steel S235 with powder coating;
- H – Steel S235 with hot dip galvanized<sup>8</sup>;
- 3 – Stainless steel 1.4301 (AISI 304)<sup>9</sup>

<sup>2</sup> Standard layer thicknesses are indicated. On request, the layers can be made in other thicknesses.

<sup>3</sup> Standard movements limits are given. On request, the profile is produced with other movements limits - ask for data.

<sup>4</sup> Vertical movements are not allowed.

## ▶ TECHNICAL DATA

<b>Material<sup>9</sup></b>	S235 (1.0038)	AISI 304 (1.4301)
<b>Strength, MPa</b>	$\sigma_s=360-510$	$\sigma_s= 515$
<b>Tolerances</b>	EN 1090-2	
<b>Length, m</b>	3,0 <sup>5</sup>	
<b>Tooling</b>	Mounting holes	
<b>Fasteners</b>	Included (Screws Rawlplug R-LX)	
<b>Surface coat</b>	• Powder <sup>7</sup> • Galvanized <sup>8</sup>	Without coating

<sup>5</sup> Profile length can be changed upon request.

<sup>6</sup> The profile is supplied assembled, using mounting brackets, to the required width of the expansion joint. Kit includes RAWL-PLUG R-LX high strength concrete screws and DIN 7991 A2 stainless steel mounting screws.

<sup>7</sup> Powder coated in any RAL color.

<sup>8</sup> Hot dip galvanizing according to EN 1461.

<sup>9</sup> The material of the layers can be changed to other types of steel: AISI 316, 321, 430, etc.

## ▶ EXECUTION OPTIONS



Using a vapor barrier for waterproofing an expansion joint.

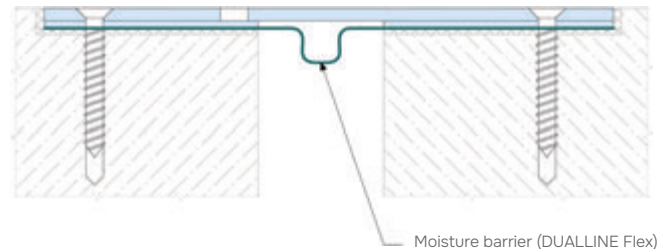

Use of a fire barrier with a fire resistance rating of up

