

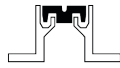

Max load  
600 kN

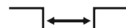

Recess  
mounted



Joint width  
20-150 mm



Movements  
in 2 directions



Indoor/  
outdoor

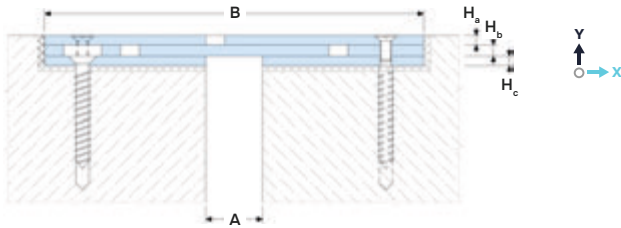

### DESIGNATIONS:

A – nominal joint width;  
B – visible width;  
H<sub>a</sub> – layer thickness “a”;  
H<sub>b</sub> – layer thickness “b”;

H<sub>c</sub> – layer thickness “c”;  
M<sub>x</sub> – horizontal movements;  
M<sub>y</sub> – vertical movements.

Profile	Standard options <sup>1</sup> (abc)	Sizes, mm		Layer thickness <sup>2</sup> (mm)			Movements <sup>3</sup> , mm		Permissible loads (kN)		
		A	B	H <sub>a</sub>	H <sub>b</sub>	H <sub>c</sub>	M <sub>x</sub>	M <sub>y</sub> <sup>4</sup>			
SG 81/20-190/15	BBB, HBB, HHB, 3BB, 33B, 333, AAA, 3AA, 33A	20	190	5	5	5	30 (+15/-15)	–	600	300	150
SG 81/30-200/15		30	200	5	5	5	30 (+15/-15)	–	600	300	150
SG 81/50-220/15		50	220	5	5	5	30 (+15/-15)	–	600	300	150
SG 81/80-260/19	BBB, HBB, HHB, 3BB, 33B, 333	80	260	5	6	8	30 (+15/-15)	–	600	300	150
SG 81/100-280/21		100	280	5	8	8	30 (+15/-15)	–	600	300	150
SG 81/120-320/23		120	320	5	8	10	30 (+15/-15)	–	600	300	150
SG 81/150-350/25		150	350	5	10	10	30 (+15/-15)	–	600	300	150

<sup>1</sup> The profile is made to order from different materials of the components of the profile layers a, b and c (see technical data):

- B – Steel S235 with powder coating;
- H – Steel S235 with hot dip galvanized<sup>8</sup>;
- 3 – Stainless steel 1.4301 (AISI 304)<sup>9</sup>;
- A – Aluminium EN AW 6063 T66

<sup>2</sup> Standard layer thicknesses are indicated. On request, the layers can be made in other thicknesses.

<sup>3</sup> Standard movements limits are given. On request, the profile is produced with other movements limits - ask for data.

<sup>4</sup> Vertical movements are not allowed.

## ▶ TECHNICAL DATA

<b>Material<sup>9</sup></b>	S235 (1.0038)	AISI 304 (1.4301)
<b>Strength, MPa</b>	$\sigma_b = 360-510$	$\sigma_b = 515$
<b>Tolerances</b>	EN 1090-2	
<b>Length, m</b>	3,0 <sup>5</sup>	
<b>Tooling</b>	Mounting holes	
<b>Fasteners</b>	Included (Screws Rawlplug R-LX)	
<b>Surface coat</b>	• Powder <sup>7</sup> • Galvanized <sup>8</sup>	Without coating

<sup>5</sup> Profile length can be changed upon request.

<sup>6</sup> The profile is supplied assembled, using mounting brackets, to the required width of the expansion joint. Kit includes RAWL-PLUG R-LX high strength concrete screws and DIN 7991 A2 stainless steel mounting screws.

<sup>7</sup> Powder coated in any RAL color.

<sup>8</sup> Hot dip galvanizing according to EN 1461.

<sup>9</sup> The material of the layers can be changed to other types of steel: AISI 316, 321, 430, etc.

## ▶ EQUIPMENT PROFILE



Steel Double sinus plates

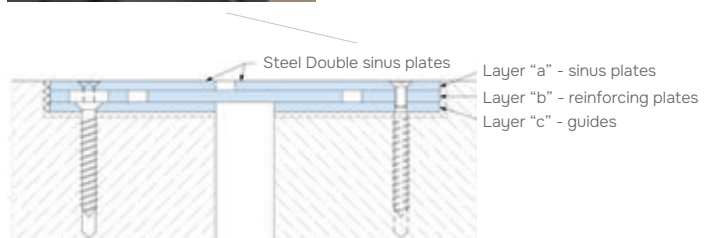

Steel Double sinus plates

Layer "a" - sinus plates

Layer "b" - reinforcing plates

Layer "c" - guides

## ▶ EXECUTION OPTIONS

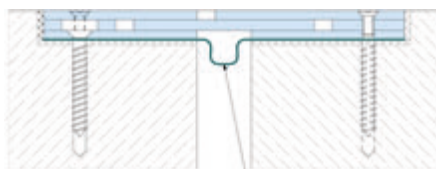

Moisture barrier (DUALLINE Flex)

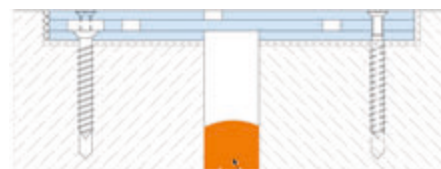

Firebarrier (EI 240)