

DUALLINE CONTROL

CRG 33

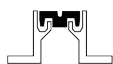

Recess mounted



Indoor/
outdoor



CRG-SS 33



CRG-AL 33

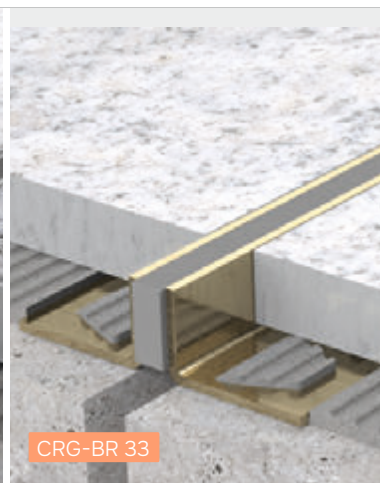

CRG-BR 33

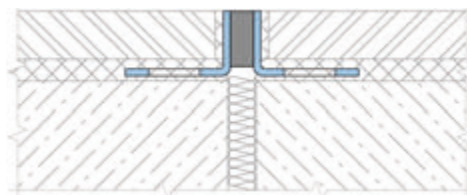
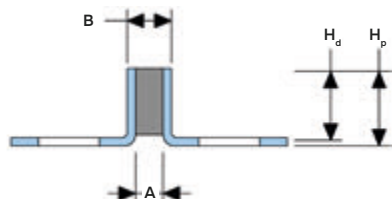

Profile	A ¹ , mm	B ² , mm	H _p ³ , mm	H _d , mm	M _x , mm
CRG 33/9/8	7	9	10	9	2(+/-1)
CRG 33/9/10	7	9	13	12	2(+/-1)
CRG 33/9/125	7	9	15	14	2(+/-1)
CRG 33/9/15	7	9	18	17	2(+/-1)
CRG 33/9/175	7	9	20	19	2(+/-1)
CRG 33/9/20	7	9	22	21	2(+/-1)
CRG 33/9/22	7	9	25	24	2(+/-1)
CRG 33/9/25	7	9	30	29	2(+/-1)
CRG 33/9/30	7	9	35	34	2(+/-1)
CRG 33/9/40	7	9	40	39	2(+/-1)
CRG 33/9/50	7	9	50	49	2(+/-1)
CRG 33/9/60	7	9	60	59	2(+/-1)

¹The standard thickness of the gasket insert is specified.

The following thicknesses are also available: - 4, 8, 12 mm.

² Visible width with 1 mm thickness of the guide brackets is indicated.

The following thick-nesses are available: - 1.5, 2 mm.

³ The profile can be manufactured to any required height.

► LABELING

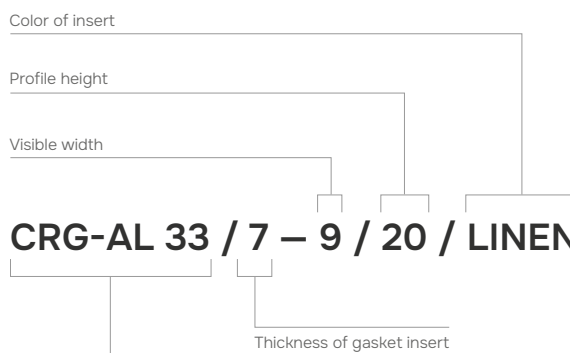

Profile Series:
CRG-AL 33 – aluminium version;
CRG-SS304/316 33 – stainless steel version (with the steel grade);
CRG-BR 33 – brass version.

► TECHNICAL DATA

Material of guide ¹	AISI 304 (1.4301)	AISI 316 (1.4401)	Aluminum 6063 or 5754)	Brass
Designation	CRG-SS304	CRG-SS316	CRG-AL	CRG-BR
Strength, MPa	$\sigma_b=515$	$\sigma_b=505$	$\sigma_b=265$	$\sigma_b=330$
Tooling	Mounting holes			
Standard length	2.44 – standard (2.50 or 3.00 meters—on request)			
Material of insert	Neoprene			
Strength, N/mm	$\sigma^e=10$			
Shore A	55			
Elongation to break	>600			
Resistance	acid, chemical and UV: excellent			
Color of insert	charcoal	pewter	light grey	earth
	sandstone	alabaster	light beige	linen
				light smoke
				milky white

► CORNER VERSION

Profiles have corner versions for Floor-to-wall connections joint along the wall). These profiles have an index "E": CRG-E.

Example: CRG-E 33/7-9/20

