

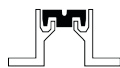

For seismic zone

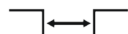

Recess mounted



Joint width 50-500 mm



Movements in 3 directions



Indoor/outdoor

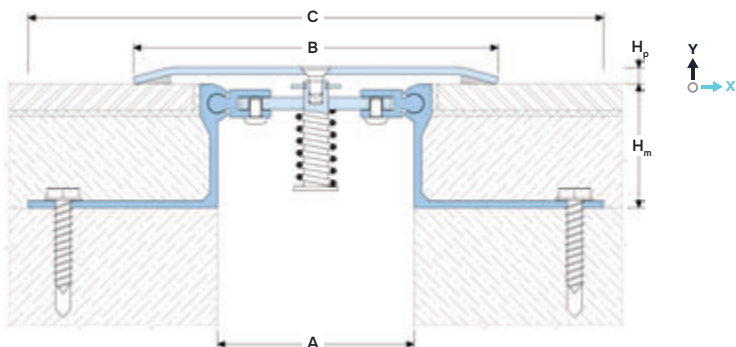
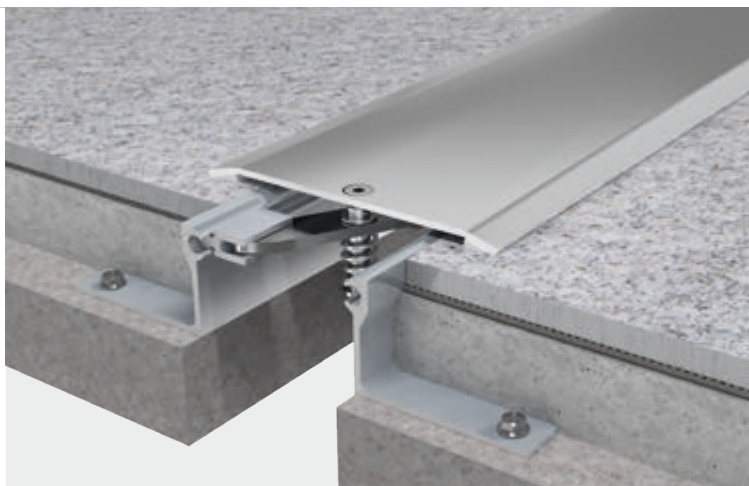

DESIGNATIONS:

A – nominal joint width; H – profile height;
 B – visible width; M_x – horizontal movements;
 C – mounting seat; M_y – vertical movements.

| Profile | Cover type ⁴ | Sizes, mm | | | | Movements ³ , mm | | Permissible loads (kN) | | | |
|----------------------------|-------------------------|----------------|------------------|-----|--|-----------------------------|-----------|------------------------|---|---|---|
| | | A ² | B ³ | C | ...=H | M_x | M_y | | | | |
| SV 35/50/... ¹ | AL / SS | 50 | 70 | 200 | 16, 20, 25, 34, 50, 70, 80, 100, 110, 120, 150, h ⁵ | 50 (±25) | 10 (±5) | 30 ⁴ | – | – | – |
| SV 35/80/... ¹ | AL / SS | 75 | 120 | 230 | | 80 (±40) | 20 (±10) | 30 ⁴ | – | – | – |
| SV 35/100/... ¹ | AL / SS | 100 | 150 | 250 | | 100 (±50) | 30 (±15) | 30 ⁴ | – | – | – |
| SV 35/150/... ¹ | AL / SS | 150 | 200 | 300 | | 150 (±75) | 40 (±20) | 30 ⁴ | – | – | – |
| SV 35/200/... ¹ | SS | 200 | 300 | 350 | | 200 (±100) | 50 (±25) | pedestrian | | | |
| SV 35/250/... ¹ | SS | 250 | 375 ² | 400 | | 250 (±125) | 80 (±40) | pedestrian | | | |
| SV 35/300/... ¹ | SS | 300 | 450 ² | 450 | | 300 (±150) | 100 (±50) | pedestrian | | | |
| SV 35/400/... ¹ | SS | 400 | 600 ² | 550 | | 400 (±200) | 120 (±60) | pedestrian | | | |
| SV 35/500/... ¹ | SS | 500 | 750 ² | 650 | | 500 (±250) | 150 (±75) | pedestrian | | | |

¹... - profile height, selected from H values.

²The profile can be made to any specific expansion joint width from 50 mm. Request additional data.

³The standard width is indicated when using a profile for seismic joints with the specified limits of movement. It is possible to reduce the width with smaller movements. The cover can be made in a choice of different materials. See "Material and Profile Designation"

⁴Constant movement is not recommended. Speed limit: no more than 5 km/h.

⁵The profile can be made to the required mounting height, where "h" is the value in mm (from 50). In this case, the profile article has the designation SV-H. Ask for details.

▶ TECHNICAL DATA

→ FRAME

| | |
|---------------|--|
| Material | Aluminum EN AW 6063 T6 (T66 ⁶) |
| Tolerances | EN 12020-2:2008 |
| Strength, MPa | $\sigma_b = 205$ (250 ⁶) |
| Length, m | 3,0 |
| Tooling | Mounting holes |
| Fasteners | Not included |

→ COVER

| | |
|----------------------------------|---|
| Material | AISI 304 ⁶ (1.4301) |
| Profile designation ⁴ | SS304-XX (XX – steel surface ⁷) |
| Strength, MPa | $\sigma_b = 515$ |
| Tolerances | EN 1090-2 |
| Length, m | 3,0 |
| Tooling | Mounting holes |
| Surface coat | Grind/brushed |

⁶On request, the cover can be made of other types of stainless steel: AISI 316, 430 or others.

⁷Choose from the types of surface coat shown

⁸For EU market

▶ LABELING

(example)

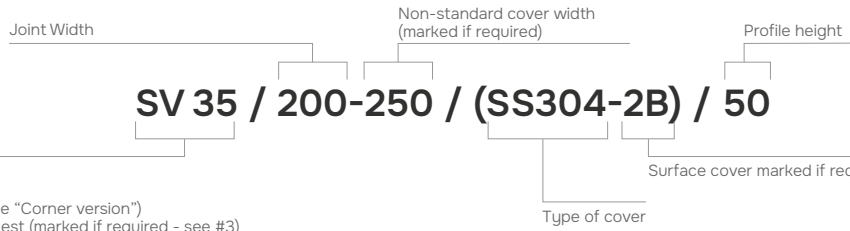

Profile Series:

SV 35 – standard version

SV-E 35 (marked if required – see “Corner version”)

SV-H 35 – profile height on request (marked if required - see #3)

▶ EXECUTION OPTIONS



Using a moisture barrier for waterproofing an expansion joint.

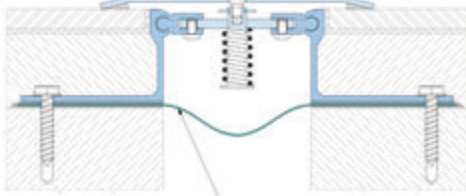

Moisture barrier (DUALLINE Flex)



Use of a fire barrier with a fire resistance rating of up to EI 240.



The profile can be made to order for the required height from 50 to 200 mm. In this case, it is completed with an assembled frame consisting of an aluminum guide and a steel angle.

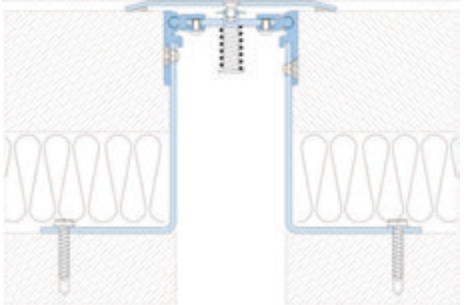

Recess - top mounted profile version (SV 33-35 or SV 34-35).

Example: SV 34-35/100-150(SS304-4N)/50

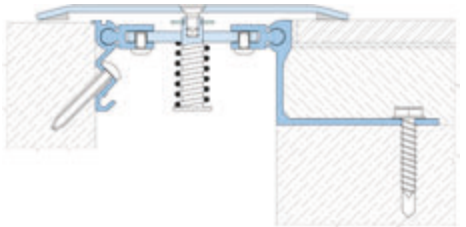

Different height version of the profile.

Example: SV 34/100-150(SS304-4N)/50

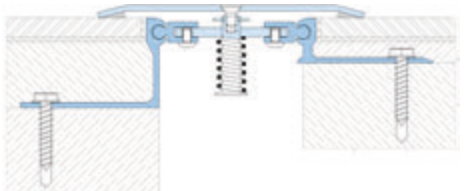

▶ EQUIPMENT PROFILE

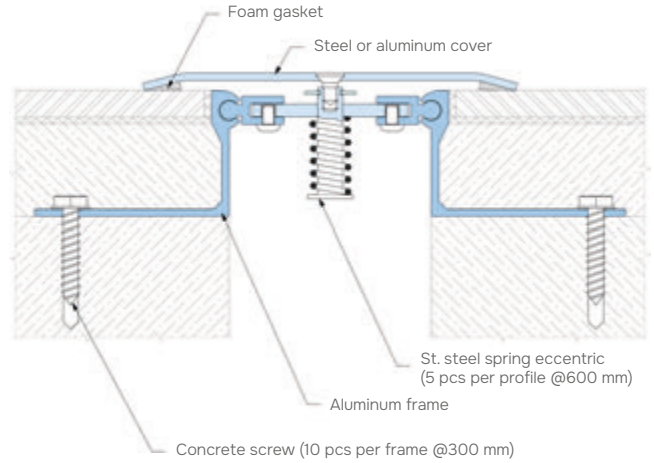

▶ ALUMINUM TYPE

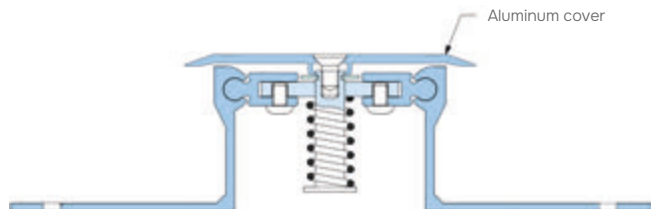

▶ CORNER VERSION

Profiles have corner versions for Floor-to-wall connections (joint along the wall). These profiles have an index "E": SV-E

Example: SV-E 35/100-150(SS304-4N)/50

