

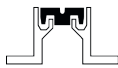

For seismic zone

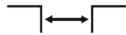

Recess mounted



Joint width 50-250 mm



Movements in 6 planes



Indoor/outdoor

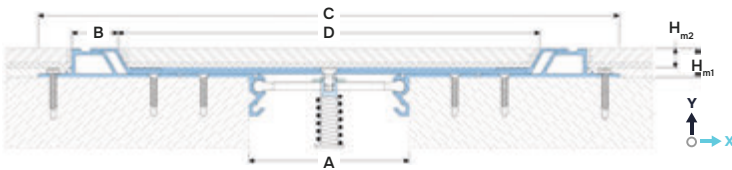

DESIGNATIONS:

A – nominal joint width; H_{m2} – depth of internal frame;
 B – visible insert width; M_s – seismic movements;
 C – full width (min mounting seat); M_x – horizontal movements;
 D – internal visible width; M_y – vertical movements.
 H_{m1} – installation height;

| Profile | Sizes, mm | | | | | | Movements, mm | | | Permissible loads (kN) | | | |
|--------------|----------------|----|-----|------------------|-----------------|-----------------|-------------------------|----------------|----------------|------------------------|--|--|--|
| | A ¹ | B | C | D | H _{m1} | H _{m2} | M _s | M _x | M _y | | | | |
| SV 26/50/18 | 50 | 30 | 315 | 215 ² | 18 | 12 | 50 (±25) ³ | 24 (±12) | -5 | pedestrian | | | |
| SV 26/75/18 | 75 | 30 | 340 | 240 ² | 18 | 12 | 80 (±40) ³ | 24 (±12) | -5 | pedestrian | | | |
| SV 26/100/18 | 100 | 30 | 365 | 265 ² | 18 | 12 | 100 (±50) ³ | 24 (±12) | -7 | pedestrian | | | |
| SV 26/150/18 | 150 | 30 | 415 | 315 ² | 18 | 12 | 150 (±75) ³ | 24 (±12) | -7 | pedestrian | | | |
| SV 26/200/18 | 200 | 30 | 465 | 365 ² | 18 | 12 | 200 (±100) ³ | 24 (±12) | -7 | pedestrian | | | |
| SV 26/250/18 | 250 | 30 | 515 | 415 ² | 18 | 12 | 250 (±125) ³ | 24 (±12) | -10 | pedestrian | | | |

¹ Standard expansion joint width shown. The profile can be made to the required width from 50 to 300 mm.

² The width of the middle part can be changed to a larger side for ease of installation of the finish coat. This also changes the value of "C".

³ M_s – allowable movements occurring in the event of seismic activity.

▶ TECHNICAL DATA

→ PROFILE

| | |
|---------------|--|
| Material | Aluminum EN AW 6063 T6 (T66 ⁴) |
| Strength, MPa | $\sigma_b=205$ (255 ⁴) |
| Tolerances | EN 12020-2:2008 |
| Tooling | Mounting holes |
| Fasteners | Included (Screws Rawlplug) |
| Surface coat | Mill finish ⁵ |
| Length, m | 3,0 |

⁴ For EU market

⁵ The profile can be optionally anodized (ask for details).

▶ LABELING

SV 26/200-600/18

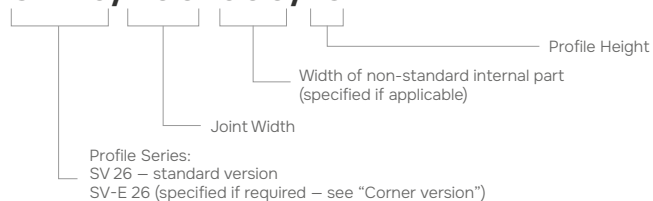

▶ TRANSITION FROM FLOOR TO WALL

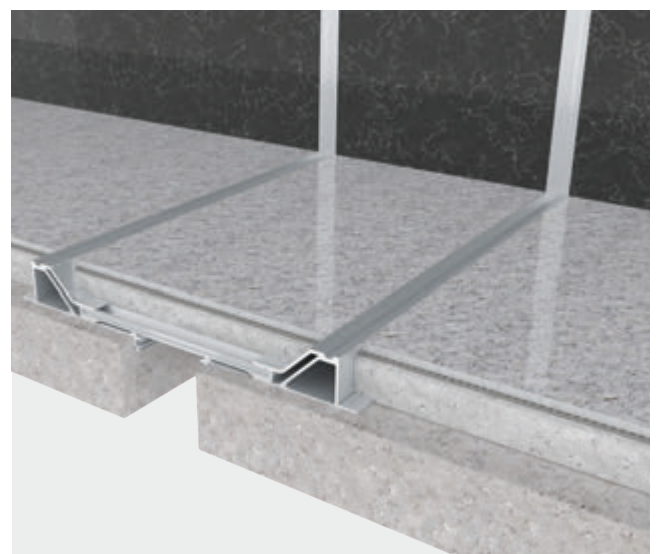

▶ EQUIPMENT PROFILE

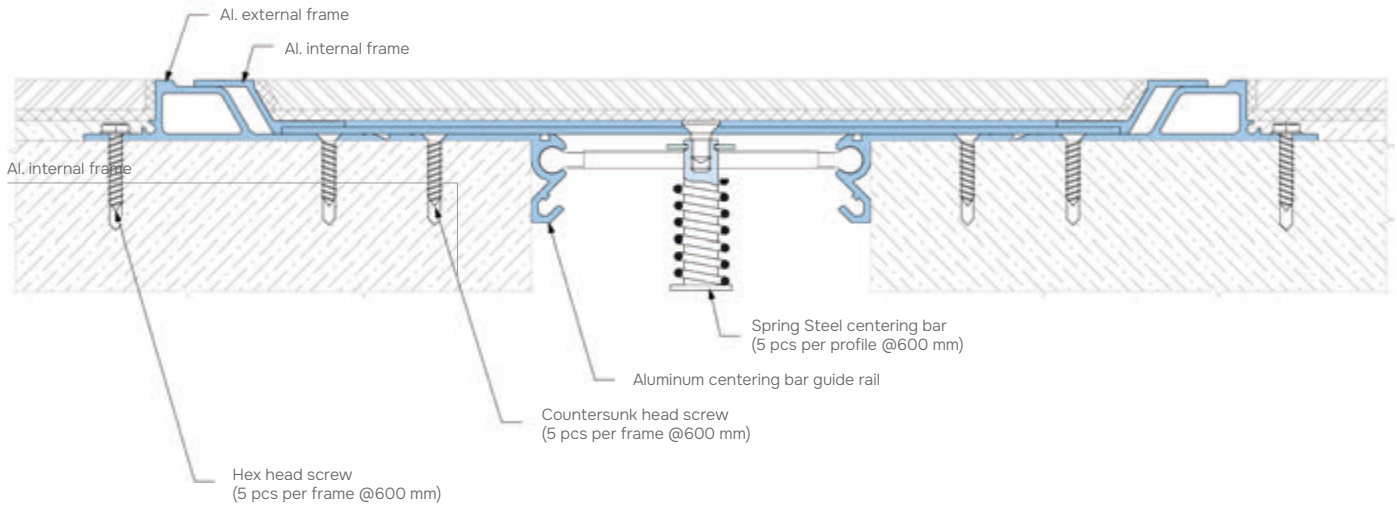

▶ EXECUTION OPTIONS

Using a vapor barrier for waterproofing an expansion joint.

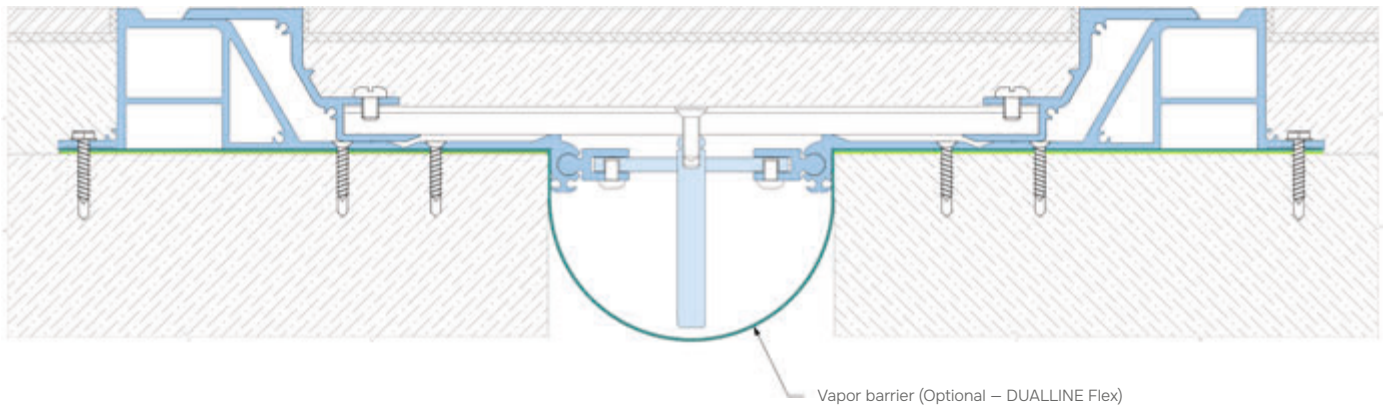

Use of a fire barrier with a fire resistance rating of up

